

Uwurgpukqp"htqpv"hqtm"ykvj">cktlekt@"l">cktlj}ftcwnke@"qt">"eqkn"urtkpilj}ftcwnke@"u{uvgo

Before using the suspension fork

Read this instruction sheet thoroughly before using the suspension fork. Using the suspension fork inappropriately may cause serious injuries. Be sure to follow all warnings and caution indications. The instruction sheet contains important information on the correct installation and usage of the fork. After reading this instruction sheet, please be sure to keep it in a safe place for future reference. When transferring ownership of the suspension fork, give this instruction sheet to the new owner. As with any new suspension fork, there is a short period within moving parts will break in. During the first 300-500 km, the ride dynamics of the fork may change slightly. One of the things you may notice, is a small amount of play in the lower tubes. This movement is normal. Suspension forks can dramatically improve the comfort and control of your bicycle, but they can also change the way it handles, so always exercise caution and good judgement when getting used to your new setup.



KORQTVCPV"UCHGV ["KPHQTO CVKQP

- 1.) Before riding the bicycle, be sure the brakes are properly installed and adjusted. If the brakes do not work properly, the rider could suffer serious injuries.
- 2.) Do not ride the bicycle if you notice bent or broken parts at the fork, especially after a collision, sounds of excessive topping out, or other indications of a possible fork failure. In these cases, take your bike to a qualified bicycle mechanic for inspection and repair.
- 3.) Always use genuine SR Suntour parts. The use of other replacement parts voids the warranty and could cause structural failure to the suspension fork.

KPUVCNNCKVQP

UT"UWPVQWT"tgeq o o gpfu"vjcv" {qwt"uwurgpukqp"htqtm"dg"kpucmngf"d {"c"swcnkLgf"dke {eng" o ge jcpke."dgecwug"kv"
 o wuv"dg"rtqrtn {"kpucmngf."cflwuvf"cpf"ejgemgf"htq"uchgv"{}
 /" Vjg"uvgggtg"vwdg" o wuv"dg"ewv"vq"rtqrtn"hgpi"vj"eqttgevn"
 /" Urgekcn"vqqu"cpf"umkmu"ctg"tgswtktg"
 /" Kh" {qw"kpucm"vjg"htqtm"d {" {qwtugnh."vjg"eq o rngvfg"kpucmckvqp" o wuv"dg"kpurgevgf"d {"c"swcnkLgf"
 " dke {eng" o ge jcpke"cpf"ukipgf"qhh"vq"xcnkfcvg" {qwt"ycttcpv"{}

Kpuvcnckvqp"kpvtwekqpu:

The SR Suntour suspension forks with hydraulic system are available only with threadless steerer: choose the right headset for this „Ahead“ type of steerer. See manufacturer’s installation guide for the headset and handlebar stem you are using!

- The SR SUNTOUR steerer tube may need cutting to the proper length.
- To cut the steerer tube is not a job for untrained people, so let a professional mechanic install the fork.
 Kh" {qw"ctg"iqpi"vq"vcemng"vjkulq"df" {qwtugnh."igv"e"iqgf"dqm"qp"tgrcktkpi"dkf"engucp"tgc"fk"ectghwmf"{}Dwv"kp"vjku
 ecug"qwt"ycttcpv" {ku"xqkf"cpf"UT"UWPVQWT"ku"pqv"nkcdng"htq"lpekfgpvcr"qt"eqpugswgpvcn"fc o cigul

1. Remove the existing fork and lower headset race from the bicycle.
 - Measure the length of the fork steerer tube against the length of the SR SUNTOUR steerer tube to determine whether it may need cutting to the proper length
2. In order to find out the proper length of the steering tube, you have to add up the following dimensions:
 - Head tube of the frame + stack height of the headset + stack height of the Clip on handlebar stem
3. Install the headset race firmly against the top of the fork crown. Install the fork assembly back on the bike.
4. Assemble the headset and handlebar stem on the bicycle. Adjust the headset so you feel no play or drag.
 - Complete the installation of the headset and stem according to the manufacturer’s instructions.
5. Reinstall the handlebar.
6. Install the brakes as per the manufactures instruction, making sure to adjust the brake properly.
 - Use the fork only with V-type brakes mounted to the existing cantilever bosses. Mount the disc brake only to the tabs provided at the left lower of the forks
7. Run the brake cable from the brake lever to the brake (V-type brake or Disc brake) making sure to leave enough cable housing to allow full travel of the fork.

Jcpfngdct"Uvg o uc

- Please use only “Ahead-type” handlebar stems for 1 1/8” (28.6mm) steerer diameter.
- Follow the handlebar stem manufacturer’s installation manual and please mind to use the proper torque for this safety item.

Jgcfugvu<

Make sure that the headset you use matches the dimensions of your fork and frame. Refer to the instruction sheet or installation manual that comes with your headset and carefully follow its instructions.

Vktg"engctcpeg<

Oczk o w o "vktg"uklg"htq"vjg"UT"Uwvqwt"uwurgpukqp"htqtm"ku"vq"dg"ejgemgf"fgrgpfkpi"qp"vjg"qwtg"fk o gvt
 hqt"4:δqt"48δ"y jgg"uklg" Cnuq." {qw" jcxg"vq"ejgem"vjg"vktg"vkvj"cpf" {qw" jcxg"vq"cmq"v" c" okpk o w o "qh"7 o o "dgv yggp"vktg"cpf"vjg"htqtm="uq"vgtu"
 Rngcug"mger"kp"okpf"vjcv"vjg"pcttq"vguv"rqkp"cv"vjg"nq"vgtu"ku"uwvcmm" {cv"vjg" jgkijv"qh"vjg"dtcmg"dqqugu" /"uq" {qw" o c f" jcxg"vq"fgfcvg"vjg"vktg"kp"ecug"
 {qw" jcxg"vq"tgo"qxg"vjg"y jgg." fgrgpfkpi"qp"vjg"vktg"vkvj"
 Dg"uwtg"vq"ejgem"vjg"vktg"fk o gvt"cpf"vkvj"y jgpexgt" {qw"ejcpig"vktgu"Vq"ejgem"vjg"vktg"fk o gvt."tg o qxg"vjg"vq"ecrulqt"cf"lwuvgt"mpqdu"cpf"
 urtkpi"uvcm"cuug o dnku"cpf"eq o r tguu"vjg"htqtm"eq o r ngvgn"vq" o cmg"uwtg"cv"ngcuv"32" o o "qh"engctcpeg"gzkuvu"dgvyggp"vjg"vq"qh"vjg"vktg"cpf"vjg"
 dqvq o "qh"vjg"etq"vp" {}Gzegfkipi" o czk o w o "vktg"uklg" ykm"ecwug"vjg"vktg"vq"lc o "c"icpuv"vjg"etq"vp"y jgp"vjg"htqtm"ku"hwmm" {eq o r tguug"{}
 Kh" {qw"vcpv"vq"tgvtq"vjg"dlmg"ykvj" o w f i w c t f u . {qw" jcxg"vq"vcmg"lpvq"ceeqw"vjg"vjg"engctcpeg"dgvyggp"vktg"cpf" o w f i w c t f "ku"pqv"ejcpigf"
 Rngcug"ejgem"vjg"engctcpeg"ci ckp"cu"fguetkdg"cdqxg"{}

Dtcmguc

The SR Suntour suspension forks are designed to be used with V-brake and Discbrake. The use of discbrake can be seen on the left side lower, where the Discbrake mounting tabs are present. Rngcug"wg"qpn"vjg" o czk o w o "fkue"dtcmg"tqvq"fk o gvt" o gpvkqpf"kp"vjku"kpvtwekqpu"jggv"/"ugg"rcig"{}70 Please check the instruction manual of the brake manufacturer for technical details and dimensions. You need to make sure that the cable housing of your brakes can move freely and does not come in contact with any part of the fork.

Oqwpvkpi"qh"vjg"tgo"qvq"ngem/qwv"ukping"ngxgt

You have the choice of two remote speed lock controls, depending on the drive train and drive train shifter types you are using.

Pqvg"Vjg"urggf"ngem"ectvtfig"ku"nqecvgf"qp"vjg"tki"jv"ukfg"qh"vjg"ngtm

"TKI"JV"CPF"NGHV"UKFG"CTG"TGHTTGF"KP"VTCXGN"FKTGEVKOP"

kh"q"jcxg"chqtm"ykvj"ckt"ectvtfig"qp"vjg"qvjgt"ukfg"rngcug"wg"vjg"ugvki"i"

qh"vjg"ckt"rtgumwte"ejctv"qp"ujqyp"qp"vjg"ckt"ectvtfig"ugvki"rcig

3h"kh"q"jcxg"chqtm"ykvj"ckt"ectvtfig"qp"vjg"qvjgt"ukfg"rngcug"wg"vjg"ugvki"i"

ngem/qwv"ngxgt"kpemwfgf"kp"vjg"ngtm"ugv"ngxgt"rj"qvq"3+0

eh Mount first the remote lock-out lever on the handlebar. Use a 2.5mm Allen key for fastening of the lever bracket (ugg"3). The position of the (upper) lock lever should be parallel to the ground - so you push vertically downwards.

dh Choose the right length of outer casing, in order to allow the unrestricted function of the fork.

eh Turn the cable tension adjustment barrel two turns counter-clockwise (5) in order to have adjustment clearance for the lock-out adjustment function.

fh Remove the plastic cover in order to access the cable fixing bolt (#4)

Thread the cable through the outer casing stopper and trough the cover cap hole and tension the cable lightly. Tighten the fixing screw using a 1.5mm Allen key(#4).

gh Cut the cable and replace the plastic cover you removed at start(#7).

lh Now push the lever to the lock position(ugg"rj"qvq"7) in order to lock the fork. Check if the fork is now locked, by pushing down the handlebar. If not, you have to adjust the tension of the cable. To unlock the fork, push the **tgf** release lever in riding direction (#6) and check if the fork is now unlocked.

Oqwpvkpi"qh"vjg"tgo"qvq"ngem/qwv"vykuv"i"tkr

eh Mount first the remote lock-out grip on the handlebar. Use a 3mm Allen key for fastening of the bracket (ugg"%). After that, you can mount the brake lever and the shifting levers.

dh Choose the right length of outer casing, in order to allow the unrestricted function of the fork.

eh Turn the cable tension adjustment barrel two turns counter-clockwise (%34) in order to have adjustment clearance for the lock-out adjustment function.

fh In order to insert the cable, you have to remove the plastic cover from the twist-grip control, using a cross or slot screwdriver(#9).

gh Check if the control is turned in the un-lock position in order to access the cable insert hole. You can use a standard shifting cable with cylindrical nipple.

Thread the cable through the hole(#10) and route it along the guiding groove in the control(#11), until the cable comes out at the cable tension adjustment barrel.

hh Replace the plastic cover on the twist-grip control and fasten the fixing screw, using again the cross or slot screwdriver.

ih Now, you can fasten the cable at the lock-out unit at the fork.

Remove the plastic cover in order to access the cable fixing bolt (#4)

Thread the cable through the outer casing stopper and trough the cover cap hole and tension the cable lightly. Tighten the fixing screw using a 1.5mm Allen key(#5).

jh Cut the cable(#6) and replace the plastic cover you removed at start.

lh Now turn the grip to the lock position(ugg"rj"qvq"36) in order to lock the fork. Check if the fork is now locked, by pushing down the handlebar. If not, you have to adjust the tension of the cable(#12). To unlock the fork, turn the grip to the front and check if the fork is now unlocked.

Nqem/qwv"hwpevkqp"ugvki"i

eh If the cable tension is too high, **vjg"ngem/qwv"ngxgt"qt"vykuv"i"tkr** will not stay engaged and keep the fork in locked position. In such case, decrease the cable tension by turning the adjustment barrel (%5/34) clockwise (-), until the lever will stay engaged.

dh If the cable tension is too low, then the fork will not be locked when you engage the lever/twist-grip. In order to increase the cable tension, turn the adjustment barrel counter-clockwise (+), until the fork will stay locked and the lever/twist-grip is still engaged.

eh In case you cannot adjust the fork using the adjustment barrel, you have to open the cable fixing screw, clamp the cable again and increase or decrease the cable tension at this point (ugg"%7). After that, you can make the fine tuning again as described at a.) and b.).

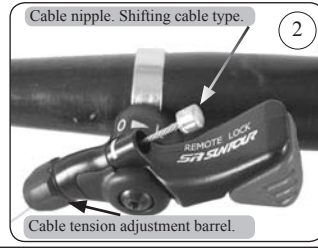
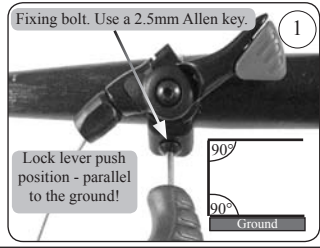

The RL lever is to be mounted on the right side of the handlerbar!

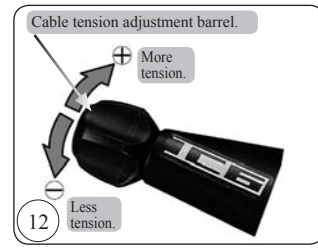
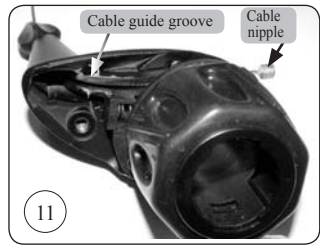
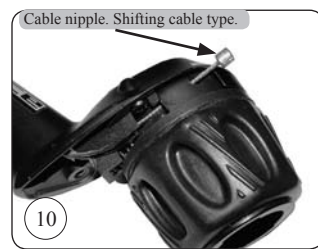
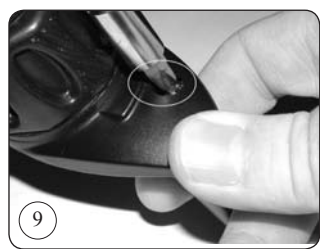
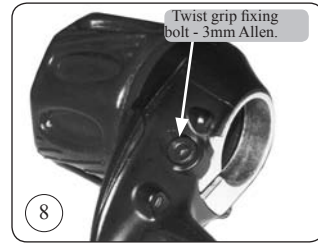
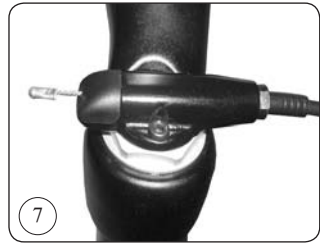
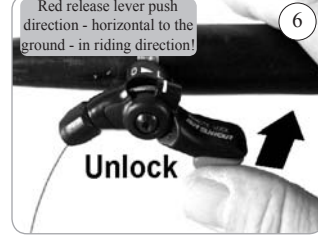
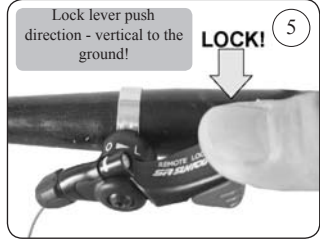
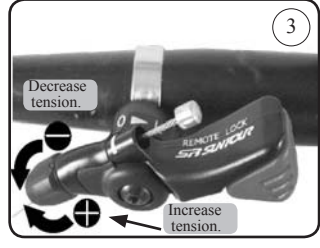

Oqwpvki "qh" v jg" tgo qvg" vtcxgn" cflwvgt" eqpvtqn

You have the choice of two remote travel adjuster controls, depending on the drive train and shifter types you are using. There is the single lever, shown in picture #1 and there is a combined travel adjust lever and remote lock-out twist grip available - see picture #11.

Pqvg<"V jg" vtcxgn" cflwuv o gpv" ectvtkf ig" ku" nqecvfg" qp" v jg" nghv" ukfg" qh" v jg" hqtm

3h+ "kh" / qw" wug" s Tcrkf" Hktgō" v / rg" qh" ujkhvgtu" / qw" jcxg" vq" wug" v jg" ukping" tgo qvg" vtcxgn" cflwvgt" ngxgt" kpenwfg" kp" v jg" hqtm" ugv" *ugg" r jvq" %" 3+0

ch Mount first the remote travel adjustment lever on the handlebar. Use a 3mm Allen key for fastening of the lever bracket (ugg" %" 3). After that, you can mount the brake lever and the shifting levers.

dh Choose the right length of outer casing, in order to allow the unrestricted function of the fork.

eh Turn the cable tension adjustment barrel (ugg" %" 5) two turns counter-clockwise in order to have adjustment clearance for the travel adjustment function.

fh At the suspension fork, remove the plastic cover cap from the travel adjust unit, using a 2.5mm Allen key (#4). Thread the cable through the outer casing stopper and through the cable clamp (#5), and push the outer casing cap firmly in the outer casing stopper.

gh Tension the cable lightly and clamp the cable firmly with the fixing bolt, using a cross or slot screwdriver (#6).

h± Cut the cable to size (#7) and replace the plastic cover, fixing it with the Allen screw, using a 2.5mm Allen key (#8).

ih At the cable end, please attach a cable end cap for your protection (#9).

j± Now press the lever (#10) and at the same time push down on the handlebar in order to compress the fork. At the end of this movement, release the lever and then the handlebar. Check if the fork stays in that position. If not, then you have to adjust the tension of the cable. To release the fork from that position, push the lever again and pull the handlebar.

Vtcxgn" cflwuv o gpv" ugvkpi

ch If the cable tension is too low, then the fork will not stay in the preselected position after you release the lever. In order to increase the cable tension, turn the adjustment barrel (#3) counter-clockwise (+), until the fork will stay in the preselected position.

eh In case you cannot adjust the fork using the adjustment barrel, you have to open the cable clamping screw and increase or decrease the cable tension at this point. After that, you can make the fine tuning again as described at a.).

Ckt" r tguwtg" cflwuv o gpv

In case it is necessary to increase or decrease the air pressure in the travel adjustment cartridge, please proceed after the following steps:

ch At the dropout level of the travel adjust cartridge side, there is the air valve for the travel adjust cartridge. Remove the air valve cover cap (see # 12).

dh Using a fork pump with pressure gauge, increase or decrease the air pressure in accordance with the chart displayed below.

5=F'DF9GG I F9'7<5FH					
Üiä^iÄ , ^i* @c		5jf' dfYgg i fY' 'Yzh g)XY		ŒiäiÄ]!^••'!^Ä lä* @cä:ä^	
läÉ	\ *	dgj	_ [Z#W a] •i	\ *-D& {
î€	HÎ	*&	(ž'	FÍ	FÉF
F€€	IÍ	++)ž(FJ	FÉI
FG€	ÍI	-'	*ž)	GH	FÉÎ
140	64	332	9.9	27	1,9
160	73	347	::	31	2,2
180	82	363	;::	35	2,5
200	91	378	32.;	39	2,7
220	100	393	34.2	43	3,0

POVg<"V jg" nghv" ukfg" r tguwtg" ku" tghgtkpi" vq" v jg" vtcxgn" cflwuv" ectvtkf ig)

V jg" tki jv" ukfg" r tguwtg" / qw" pggf" kp" ecug" qh" cp" ckt" u / uvg o" qp" v jg" hqtm" u" tki jv" ukfg)

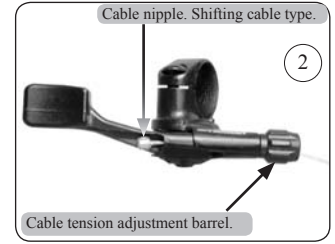
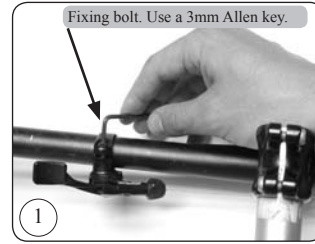

The TA lever is to be mounted on the left side of the handlebar!

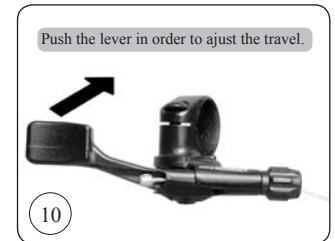
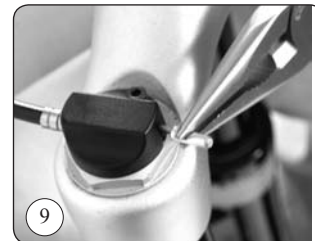
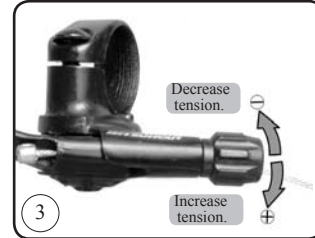

Eqxgt" ecr" cpf" xcxcg" qh" v jg" ckt" urtkpi" u { uvg o" ukfg" qh" v jg" hqtm

"QRGTCVKP I "V J G" OCPWCN"NQEM/QWV"U [UVG O

Wug"cpf"hwpevkqp"qh"vjg"nqem/qwv"u{uvgo

The lock-out function of the SR Suntour forks is intended to reduce bobbing during your sprinting action or uphill ride. The fork will not be as hard as a rigid fork, if you press with your full weight on the handlebar, but you will feel a big difference between locked and un-locked mode. In order to activate this function, you have either to push the "wishbone" shaped lever to the right - in case of a remote lock-out fork or to turn the lock-out knob located on the right side of the fork crown clockwise up to stop. In order to open the system for normal damping, you have to push the "wishbone" lever to the left in the case of a remote lock-out fork or turn the lock-out knob counter-clockwise. To perform both functions - lock or un-lock -> you need only one flip of your thumb in the case of the remote lock-out fork or a full turn of the lock-out knob for a standard lock-out fork.

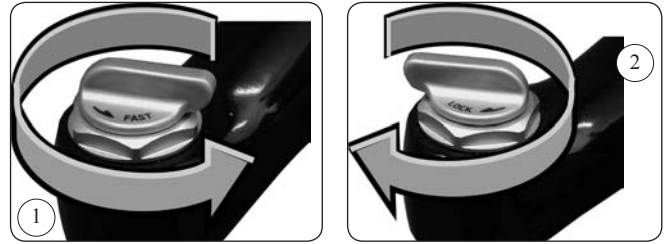

Pqvg<V jg"Nqem/qwv"ectvtkf ig"ku"nqecvfg"qp"vjg"tki jv"ukfg"qh"vjg"hqtm

Y ctpkpi<Rngcug"fqg<v"wg"vjg"hqtm"kp"nqem/qwv" o qfg"v jgp"tkfkpi"qp"tqwi j" vgttckp"qt"lw o rkpil"Jki j"nqcf"wpfgt"nqem/qwv"eqpfkqap"oki jv"ngcf"vq"e" egtvckp"fc o cig"v jke" o c"tguwv"kpvg"dtgcmc ig"qh"vjg"TNINO"ectvtkf ig

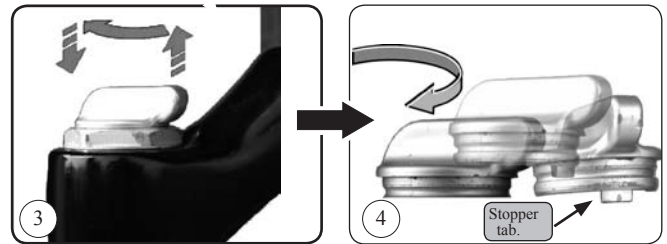

Cflwuv o gpv"qh"vjg"nqem/qwv"u{uvgo "hqt" OVD"hqtmu

3l+Cflwuv o gpv"hqt"vjg"ecug"vjg"hqtm"uvknn" o qxgu"jctf"kp"vjg"hwmmf"wpnqemgf" rqukvkq

In the fully opened (hew) position of the lock-out knob, you have to pull up the knob, move it clockwise for about 45° and insert it back into the top cap. As such, you gain 45° up to the stopper position and you can un-lock more the cartridge. After this step, check again the function. Please check also, if the system is locking when you turn the knob to the "lock" direction until the stopper tab. (See movement from picture #3 and #4)

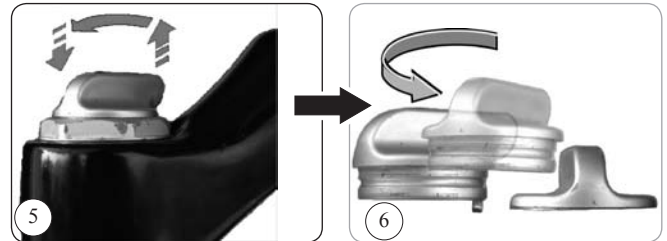

4l+Cflwuv o gpv"hqt"vjg"ecug"vjg"hqtm"ku"uvknn"wp/nqemgf"kp"vjg"hwmmf"nqemgf" rqukvkq

In the fully closed (lock) position of the lock-out knob, you have to pull up the knob, move it counter-clockwise for about 45° and insert it back into the top cap. As such, you gain 45° up to the stopper position and you can lock more the cartridge. After this step, check again the function. Please check also, if the system is un-locking when you turn the knob to the "fast" direction until the stopper tab (see movement from picture #5 and #6).

"QRGTCVKP I "V J G" J [FTCWNKE"TGdQWPF"FCORkP I

Wug"cpf"hwpevkqp"qh"vjg"j f ftcwnke"tgdqwpf"fc o rkp i

The rebound damping function of the SR Suntour hydraulic forks is intended to allow you to tune your fork's rebound speed to your personal preferences and the terrain you're riding.

Kpetgug"tgdqwpf"urggf

In order to increase the speed of the rebound, you have to turn the adjustment knob located at the level of the right dropout counter-clockwise (see #7). In case the rebound speed is still too slow for you, you may go to a authorized local dealer and ask him to exchange the standard fork oil we use (5W) to a oil with lower viscosity (for example 2.5W)

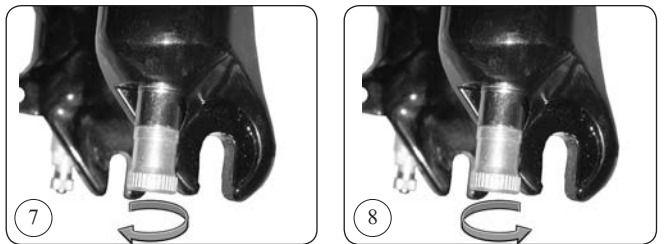

Fgetgug"tgdqwpf"urggf

In order to decrease the speed of the rebound and make it slower, you have to turn the adjustment knob clockwise (see #8).

"QRGTCVKP I "V J G"EQkN"URTKP I "RTGNQCF"CFLWUVGTU

Wug"cpf"hwpevkqp"qh"vjg"eqk"urtkpi"rtgnqcf"cflwuvgtu

The preload adjustment of the SR Suntour forks is intended to allow you to tune your fork's „SAG“ to your personal weight. The „SAG“ is the amount of travel the fork compresses when you sit up your bike.

Tgfweg"UCI

In order to reduce SAG, you have to turn the preload adjuster knob clockwise (see #9). While you do so, the yellow marker in the transparent window will move down (see # 10). The fork is delivered set at minimum preload.

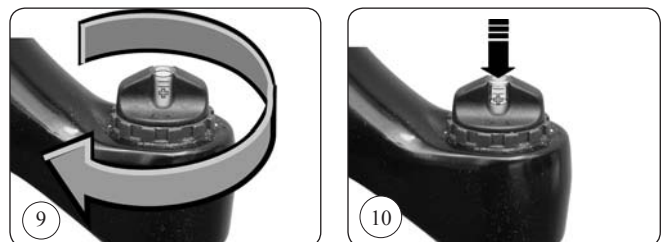

Kpetgug"UCI

In order to increase SAG, if you adjusted the preload of the coil spring too high, you have to turn the preload adjuster knob counter-clockwise. While you do so, the yellow marker in the transparent window will move up. For the proper amount of SAG, please see „Fork performance tuning“ - page 5.

"QRGTCVKP I "V JG" TGOQVG" VTCXGN" CFLWUV OGPV

Wug"cpf"hwpevkqp"qh"vjg"tgo qvg"vtcxgn" cflwuv o gpy

This feature allows you to adjust the travel of your fork depending on your preferences and the terrain you're riding. The travel adjustment allows you to change the way the bike handles, when you ride uphill or downhill.

Y jgp" {qw"tkfg"wr jkm, you push the lever (which is mounted on the handlebar) and push down the handlebar. You release the lever at the desired travel level of the fork. Now you can ride uphill in a more comfortable body position.

Y jgp" {qw"tkfg"fqyp jkm, you push the lever and pull the handlebar and the fork extends its travel to the maximum travel level. Now you can ride downhill in a more comfortable and safer body position.

The infinitely variable travel can be adjusted from 60-120mm (130mm - depending on the fork model) steplessly.

Tgoctm: The changement of the travel of the fork doesn't change the air spring rate. You have the same comfort at all travel levels.



"QXGTXKIG Y "QH"V JG" HQTM"U [UVGOU" TGHGTTGF" VQ"KP"V JKU" OCPWCN

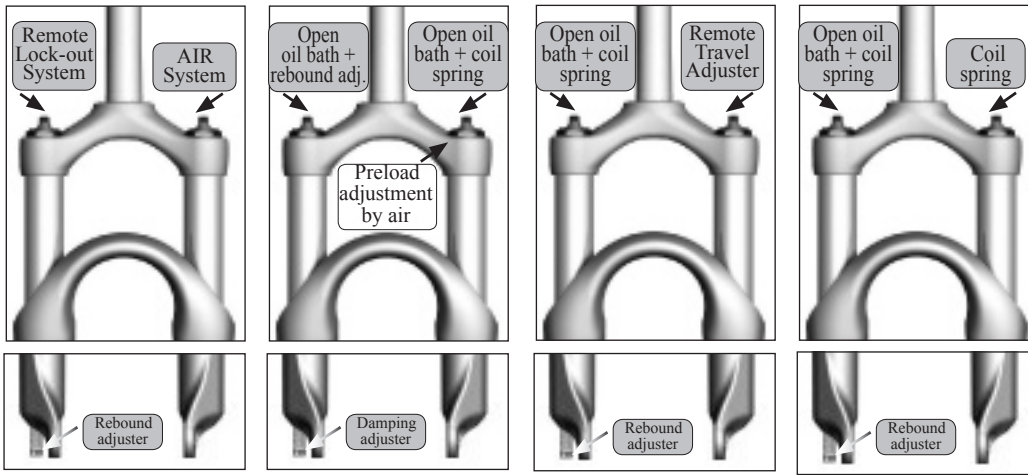

SF7-AXON RLD
SF7-EPICON RLD
SF7-NRX-RLD
SF7-RUX-S
SF7-XC-PRO-TAD
SF7-DURO-DJ-E
SF7-DURO-DJ-D

Max. possible discbrake rotor diameter:

SF7-DURO DJ	= 210mm
SF7-RUX	= 210 mm
SF7-XC-PRO	= 185mm
SF7-AXON	= 185mm
SF7-EPICON	= 185mm
SF7-XCR	= 185mm
SF7-XCM	= 185mm
SF7-NRX	= 185mm
SF7-NCX	= 185mm

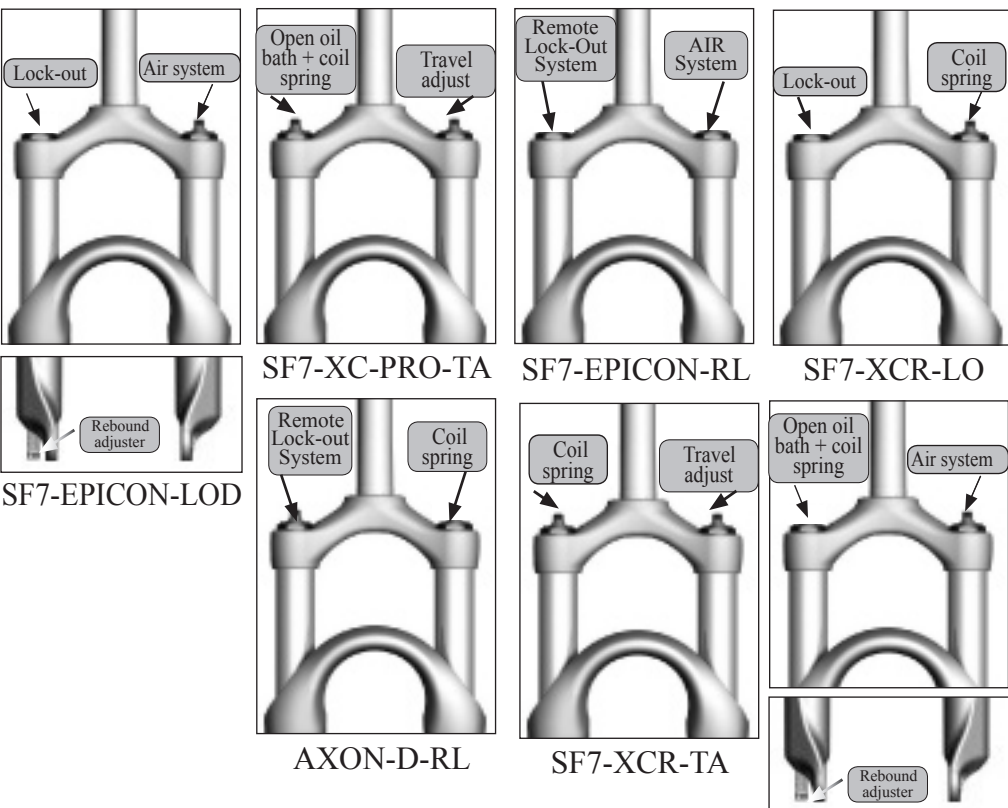

SF7-EPICON-LOD
SF7-XC-PRO-TA
SF7-EPICON-RL
SF7-XCR-LO
AXON-D-RL
SF7-XCR-TA
SF7-EPICON-DA

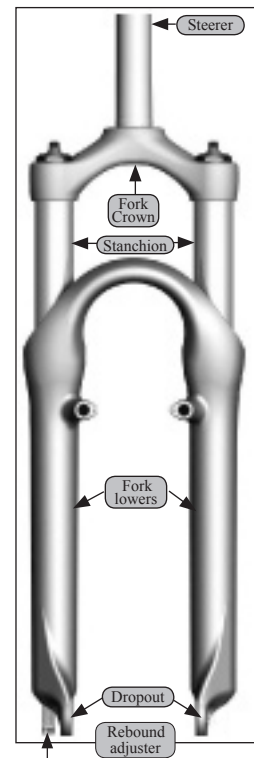

PQVG< [qwi" hqtm-u" crrgtcpeg" oc / xct / "htqo" vjg" ko cigu" wj qyp" kp" vjku" Qypgt-u" o cpwcn] Hqt" ncvgn" kphqt o cvkqp" rncug" xkukv" qwt" y gdukyg< Y Y YUTUWVPVQWT/E [ENKP I]EQO

"Hqtm"rgthqt o cpeg"vwpkp i

Hqtm"rgthqt o cpeg"vwpkp i

The SR Suntour suspension forks can be tuned for your particular weight, in accordance with the terrain and your personal riding style.

Ugvkpi"Uci

Suspension forks will sag(dive in) more or less, depending on your weight and fork setting, when you mount the saddle and sit on your bike. The proper adjustment of sag allows the front wheel to keep contact with the ground during the ride. Sag is adjusted by increasing or decreasing (depending of the fork model) the:

ch"vjg"rqkvkxg"ckt"rtguwtg / dl"vjg"rtgnqcf"qp"vjg"urtkpi"uvcemu.

To measure the amount of sag your fork is diving in, install a zip tie on the stanchion tube, at the level of the lower tube seal.

Now, mount the saddle and sit on the bike in normal riding position, ride a short distance on flat ground and step off the bike.

Measure the distance between the lower seal and the zip tie and you will find out the sag. In case of travel adjustment forks,

set the fork to maximum travel (120mm) and check in accordance with the chart shown above.

Vtexgn" "	Kpygpfgf"wgug" "	Uci
80 mm	Racing	8-12 mm
80 mm	XC	12-16 mm
100 mm	Racing	10-14 mm
100 mm	XC	14-18mm
130 mm	Freeride	20-25mm

cl"Ugvkpi"UCI"d{"ckt"rtguwtg

In order to adjust the air pressure, please be sure to use the following steps

***Tki jv"cpf"nghv"ukfg"ctg"vg"dg"eqpukfgtgf"htqo"vjg"tkfgtaw"rgturgevkgxg+:**

- 1.) unscrew by hand the cover cap on the left or right side of the fork crown.
- In case of a travel adjustment fork, please find the air valve at the left lower dropout..
- 2.) attach the suspension fork air pump at the "Schrader" valve.
- 3.) pump up the fork to the desired hardness level -> see chart.
- 4.) remove the pump from the valve.
- 5.) replace the cover cap.

AIR SPRING SYSTEM

TRAVEL ADJUST SYSTEM



dl"Ugvkpi"UCI"d{"urtkpi"rtgnqcf

In order to adjust the Sag by spring preload, measure first - as described above - the initial Sag, using the zip tie method.

After you found out the amount of Sag you have, reduce or increase it, by using the preload knob on the top of the fork crown.

By turning the preload knob clockwise, you increase the preload and reduce the SAG.

By turning the preload knob counter-clockwise, you reduce the preload and increase the SAG. Please adjust the SAG in accordance with your personal preferences and use the values indicated above as guidance. If you are not able to adjust the optimum SAG, you need to change the fork's coil springs, to harder or softer ones.

4229" o qfgmu"ejctv"kphtq o cvkqp"wrqp"qkn" c o qwpv"*EE+"cpf"ckt"rtguwtg"*RUK+

	A cXY`	hmlY	ftUj Y`fa a t	Yzn	fj[\h	j]gVtglm	Yzn	fj[\h
	G: + F i l `G	cdYb VUH	% \$ / % \$	% \$ VW	% \$ VW	% \$ K	% dgj	bc
	G: + F i l `9	cdYb VUH	% \$ / % \$	% \$ VW	% \$ VW	% \$ K	% dgj	bc
	G: + 8i fc `8 > 9	gYa]!WffjX[Y`	, \$z%\$\$ / % \$, \$ VW	bc`c]	% \$ K	bc	bc
	G: + 8i fc `8 > 8	gYa]!WffjX[Y`	, \$z%\$\$ / % \$, \$ VW	bc`c]	% \$ K	bc	bc
	G: + 8i fc `8	gYa]!WffjX[Y`	% \$\$ / % \$, \$ VW	bc`c]) K	bc	bc
	G: + L Vdfc `H58	gYa]!WffjX[Y`	%(\$!* \$	- \$ VW	bc`c]) K	% \$ \$dgj	bc
	G: + 5i cb `F @B	gYa]!WffjX[Y`	, \$ / % \$\$	+) VW	bc`c]	% \$ K	% \$ \$dgj	bc
	G: + 9d]Vtb `F @B	gYa]!WffjX[Y`	, \$z%\$\$z%\$\$ / % (\$,) VW	bc`c]	% \$ K	% \$ \$dgj	bc
	G: + 9d]Vtb `F @	gYa]!WffjX[Y`	, \$z%\$\$z%\$\$ / % (\$,) VW	bc`c]	% \$ K	% \$ \$dgj	bc
	G: + 9d]Vtb `C 8	gYa]!WffjX[Y`	, \$z%\$\$z%\$\$ / % (\$,) VW	bc`c]	% \$ K	% \$ \$dgj	bc
	G: + 9d]Vtb `85	gYa]!WffjX[Y`	, \$z%\$\$z%\$\$ / % (\$,) VW	bc`c]	% \$ K	% \$ \$dgj	bc
	G: + BFL `F @B	gYa]!WffjX[Y`	** / +)	() VW	bc`c]	% \$ K	% \$ \$dgj	bc
	G: + BFL `F @	gYa]!WffjX[Y`	** / +)	() VW	bc`c]	% \$ K	% \$ \$dgj	bc
	G: + BFL `85	gYa]!WffjX[Y`	** / +)	() VW	bc`c]	% \$ K	% \$ \$dgj	bc
	G: + B7L! : H!G!F @		**				% \$ \$dgj	bc
	G: + B7L! : H!9!F @		**				% \$ \$dgj	bc
	G: + B7L!G!F @		**				% \$ \$dgj	bc
	G: + B7L!9!F @		**				% \$ \$dgj	bc
	G: + 7F - - \$!@C		**				% \$ \$dgj	bc

" OCKPVGPCPEG



E jgem"vjg"hgqtm"dghqtg"gej"tkfg"cpf"eqpvcev" {qwt"fgcngt"kh" {qw"jcxg"cp {"swgukqpu0"

E jgem"hgqmqykp i"rqkpvu<

- a) Visible damage of the fork - on upper or lower tubes, fork crown, brace, dropouts - like cracks, dents, as effects of a crash during the ride or of other causes.
- b) Tightness of the headset by pressing the braking lever of the front brake and pushing and pulling the bike in order to see if there is play.
- c) Brake pad adjustment on the rim and distance to the rim (1-2 mm is optimal)
- d) Brake lever travel - ideally the contact of the brake pad and rim should occur after 1/3 of lever travel range
- e) Firmness of the brake assembly - apply the brakes several times and check carefully for loose nuts, bolts, etc.
- f) Front wheel must be centred within the fork tubes. Check proper torque on wheel quick release mechanism.

OckpvGPCPEG

SR SUNTOUR forks are designed to be nearly maintenance free. However, as long as moving parts are exposed to moisture and contamination, performance may be reduced. To maintain high performance, safety and long life, periodic maintenance is required.

The recommended intervals for maintenance are listed below.

Lubricants and Cleaners:

- Teflon fortified oil
- SR SUNTOUR special grease (SRS No.9170-001) / high quality Teflon fortified grease.

Damping oil:

- SR SUNTOUR special damping oil (SR SUNTOUR special damper oil #PSF01-033 / Viscosity 5W).

Tgiwnc"OckpvGPCPEG<

Dghqtg"gxgt"tkfg."kpurgev"vjg"hgqmqykp i"rctvu:

- a) Front wheel and quick release for proper installation and adjustment
- b) Fork for any obvious damage (crown, brace, upper tubes, lower tubes, and dropouts)
- c) Front brake cable for proper routing
- d) Front brake pads for proper contact with the rim / wear down of disc brake pads
- e) Front brake lever for proper adjustment and function
- f) Headset for proper function and adjustment
- g) Stanchion tubes for scratches. In case of deeper scratches contact your local dealer for advice.

Kh" {qw"tkfg"kp"gzvtg"og"ygcvtjgt"qt"vgttckp"eqpfkqkqpu."yg"tgeqo"ogpf" c"oqtg"htgswgpp"o ckvGPCPEG!



Kp"cp {"ecug."kh" {qw"hggn"vjcv" {qwt"hgqtmou"rgthqt o cpeg"jcu"ejcpigf"qt"kv"jcpfngu"fkhhgtgppv" {"cu"pqt o cu" / " rncug"eqpvcev"ko"ogfkvcgn" {"qwt"nqecn"fgcngt"vq"kpurgev" {qwt"hgqtm0

We recommend the service after 50 and 100 hours of riding to be performed by a qualified bicycle mechanic. He has all necessary tools for this service and the necessary know-how.

OCKPVGPCPEG	<i>0-50h</i>	<i>50-100h</i>	<i>100-250h</i>	<i>250-500h</i>
Clean the stanchion tubes and the dustseal area	/			
Check the main fixing bolts for proper torque (10Nm)		/		
Oil the dustseal area with Teflon oil or other fork oil		/		
Function check of the fork/Clean and grease service of the bushings at the dealer			/	
Change oil bath and lubricate remote lock and travel adj. beneath cap with Teflon oil				or twice a year
Inspection and service of the complete fork at the dealer				/ or 1 year

KORQTVCPV"CFXKEG"HOT"HOTMUGTXKEG

The suspension fork requires periodic maintenance, as moisture and contamination may build up inside the fork depending on the weather conditions during your ride. In order to maintain the fork's proper performance, we recommend periodical disassembly, cleaning and lubrication at the dealer - especially before you intend not to use your bike for a longer period of time.

NEVER USE A HIGH PRESSURE SPRAY GUN FOR CLEANING YOUR FORK, AS WATER MAY ENTER AT THE DUSTSEAL LEVEL!.

The periodic greasing of the dustseals is very important, as it is linked directly with the smooth function of the fork. As such, any time you feel that the fork isn't moving as smooth as before, even after you oiled the fork after each 25hours of use - please ask the dealer to dis-assemble the fork and clean and grease the dustseals and metal bushings.

FOR THE SERVICE AT THE DEALER, PLEASE BRING THE FORK ALWAYS IN CLEANED CONDITION!
Please keep in mind, that a fork which was not serviced periodically in accordance with the maintenance recommendations will loose it's warranty.

Pqvgu"qp"wucig"qh"vjg"hqtm"

Kpvpgfgf"wug



The SR Suntour suspension forks are designed for Endurance/Freeride and moderate downhill riding (air system/hydraulic type forks) and Cross Country and All Mountain (hydraulic system/spring type forks).

Fq'pq'wug'ht<Htgetkfg'gzvtg o g l Fqy p j km tcekpi l Fktv'lw o rgt###/'wug' { qwt'hqtm'qpnf'lp'ceeqtf cpeg' y kv j'vjg'vctig'wug'ujqvp'denqy#
 Detailed information about the target category of your fork you can find on our website at - WWW.SRSUNTOUR-CYCLING.COM
 Please check the point "Bike basics" on our website, in order to understand the target categories of our forks.

Z/EQPVT [FKTV' LWOR	CNN' OQWPVCKP	ETQUU*922E+	HTGGTKFG	VTGMMKPI	ETQUU*922E+
AXON-RLD	DURO-DJ triple	EPICON-RLD	NRX-RLD-LTD	RUX TRIPLE	CR990-LO	NCX-FT-D-RL
	DURO-DJ-E	EPICON-RL	NRX-RLD	RUX-S	CR940-LO	NCX-FT-D-LO
	DURO-DJ-D	EPICON-LOD	NRX-RL	RUX-E		NCX-S-RL
		EPICON-DA	NRX-DA			NCX-E-RL
		XCR-TA	NCX-FT-S-RL			NCX-D-RL
		XCR-RL	NCX-FT-E-RL			NCX-D-LO



Kh"ht"cpf"tgcupq" { qw'hggv'jcv'vjg'tg'ku'uq o gv jkpi" v tqpi" v kv j'vjg'hqtm."d f'v jg'v c f'kv" j c p f n g u' q t' d f' w p w u w c n" v q r r i p i' u q w p f u. { q w' o w u v' k o o g f k e v g n f' u v q r' w u k p i' k v' c p f' { q w' j c x g' v q' v c m g' k v' v q' v j g' f g c n g t' h t q o' v j k e j' k v' v c u' r w t e j c u g f. " h t' k p u r g e v k p l

NKOKVGF" YCTTCPV I "

SR SUNTOUR warrants the suspension front fork to be free from defects in materials and workmanship under normal use for a period of two years from the date of purchase. In no event shall this limited warranty apply to any defect of the suspension fork caused by: improper installation, disassembly, re-assembly, intentional breakage or damage, alterations or modifications to the suspension fork by the user or other party or any unreasonable use or abuse of the product or any use for which this product was not intended.

The obligation of this limited warranty shall be limited to repairing or replacing the suspension fork or any part for which there is a defect in materials or workmanship during the two years following the date of purchase. To validate this limited warranty the purchaser must submit this warranty card to SR SUNTOUR within 30 days after purchase of the suspension fork. Any alteration of, or tampering with the warranty card automatically terminates this limited warranty.

SR SUNTOUR makes no express or implied warranties of fitness or merchantability of any kind, except as set forth above. SR SUNTOUR's liability hereunder is expressly limited to repair or replacement of the product. Under no circumstances will SR SUNTOUR be liable for incidental or consequential damages. Some jurisdictions do not allow the exclusion or limitation of liability of incidental or consequential damages, so the above exclusion may not apply to you. This warranty gives you specific rights and you may have other rights which vary from jurisdiction to jurisdiction.

In all places, the purchaser should contact the place of purchase for information about warranty service.

Uwurgpukqp"Hqtm" Ycttcpv { "Ectf<

Date of purchase: _____ Fork model name _____ Serial number _____

Term of limited warranty: Two years from the date of purchase

"Fgcngt Name: _____ Phone#: _____

Address: _____

Rwtejcugf Name: _____ Phone#: _____

Address: _____

This warranty is void without proof of purchase.

UGTXKEG"CV"VJG"FGCNGT

1st. service / Date: _____ Signature of the dealer: _____ Stamp: _____

2nd. service / Date: _____ Signature of the dealer: _____ Stamp: _____

3rd. service / Date: _____ Signature of the dealer: _____ Stamp: _____

You may use also the dealer's own business stationary in order to prove the date and frequency of the service intervals.

SR SUNTOUR INC.
 No.7 Hsing Yeh Road, Fu Hsing Industrial Zone.Changhua.50606. Taiwan, R.O.C.
 Tel:00886-4-7695115 / Fax: 00886-4-769 4028 / E-mail: orders@srsuntour.com.tw

SR SUNTOUR EUROPE GMBH
 Am Marschallfeld 6a, 83626 Valley / Germany
 Phone: 49-8024-3038152 / Fax: 49-8024-4730984
 E-mail: service@srsuntoureurope.com

SR SUNTOUR USA
 503 Columbia street, Vancouver, WA 98660, USA
 Tel: 1- 360 737 6450 / Fax: 1 360 737 6452 /
 E-mail: service@usulcorp.com

SR SUNTOUR INC.
 Specifications are subject to change without notice.
 Printed in TAIWAN.